

VICINITY MAP
SCALE: 1" = 1200'



SCALE: 1" = 300'

LEGEND

--- ENHANCED INFRASTRUCTURE FINANCING DISTRICT
(EIFD) No. 1A - THE RIVERS

FILED IN THE OFFICE OF THE CITY CLERK OF THE CITY OF
SACRAMENTO THIS _____ DAY OF _____, 20____.

KRYSIS RANKIN
CITY CLERK
CITY OF WEST SACRAMENTO

I HEREBY CERTIFY THAT THIS MAP SHOWING THE PROPOSED BOUNDARIES
OF THE ENHANCED INFRASTRUCTURE FINANCING DISTRICT (EIFD) No. 1A - THE RIVERS
IN BOOK _____ OF MAPS, AT PAGE _____, 201____, AT THE HOUR OF _____ O'CLOCK _____ M.,
SACRAMENTO COUNTY OF YOLO, STATE OF CALIFORNIA, WAS APPROVED BY
THE CITY COUNCIL OF THE CITY OF WEST SACRAMENTO AT A REGULAR
MEETING THEREOF, HELD ON THE _____ DAY OF _____, 201____, BY
RESOLUTION No. _____.

KRYSIS RANKIN
CITY CLERK
CITY OF WEST SACRAMENTO

FILED THIS _____ DAY OF _____, 201____, AT THE HOUR OF _____ O'CLOCK _____ M.,
IN BOOK _____ OF MAPS, AT PAGE _____, IN THE OFFICE OF THE COUNTY RECORDER OF
THE COUNTY OF YOLO, STATE OF CALIFORNIA.

FREDDIE OAKLEY
COUNTY RECORDER
COUNTY OF YOLO

**PROPOSED ENHANCED INFRASTRUCTURE FINANCING DISTRICT
(EIFD) No. 1A - THE RIVERS
CITY OF WEST SACRAMENTO,
COUNTY OF YOLO,
STATE OF CALIFORNIA**



VICINITY MAP
SCALE: 1" = 1200'

LEGEND

--- ENHANCED INFRASTRUCTURE FINANCING DISTRICT
(EIFD) No. 18 - RIVERPOINT

FILED IN THE OFFICE OF THE CITY CLERK OF THE CITY OF WEST SACRAMENTO THIS ____ DAY OF _____, 201__.

KATYSS RANKIN
CITY CLERK
CITY OF WEST SACRAMENTO

I HEREBY CERTIFY THAT THIS MAP SHOWING THE PROPOSED BOUNDARIES OF ENHANCED INFRASTRUCTURE FINANCING DISTRICT No. 18, CITY OF WEST SACRAMENTO, IS A TRUE AND CORRECT COPY OF THE MAP AS APPROVED BY THE CITY COUNCIL OF THE CITY OF WEST SACRAMENTO AT A REGULAR MEETING THEREOF, HELD ON THE ____ DAY OF _____, 201__., BY ITS RESOLUTION No. _____.

KATYSS RANKIN
CITY CLERK
CITY OF WEST SACRAMENTO

FILED THIS ____ DAY OF _____, 201__ AT THE OFFICE OF THE COUNTY RECORDER OF THE COUNTY OF YOLO, STATE OF CALIFORNIA.

DERRINE GASKLEY
COUNTY RECORDER
COUNTY OF YOLO

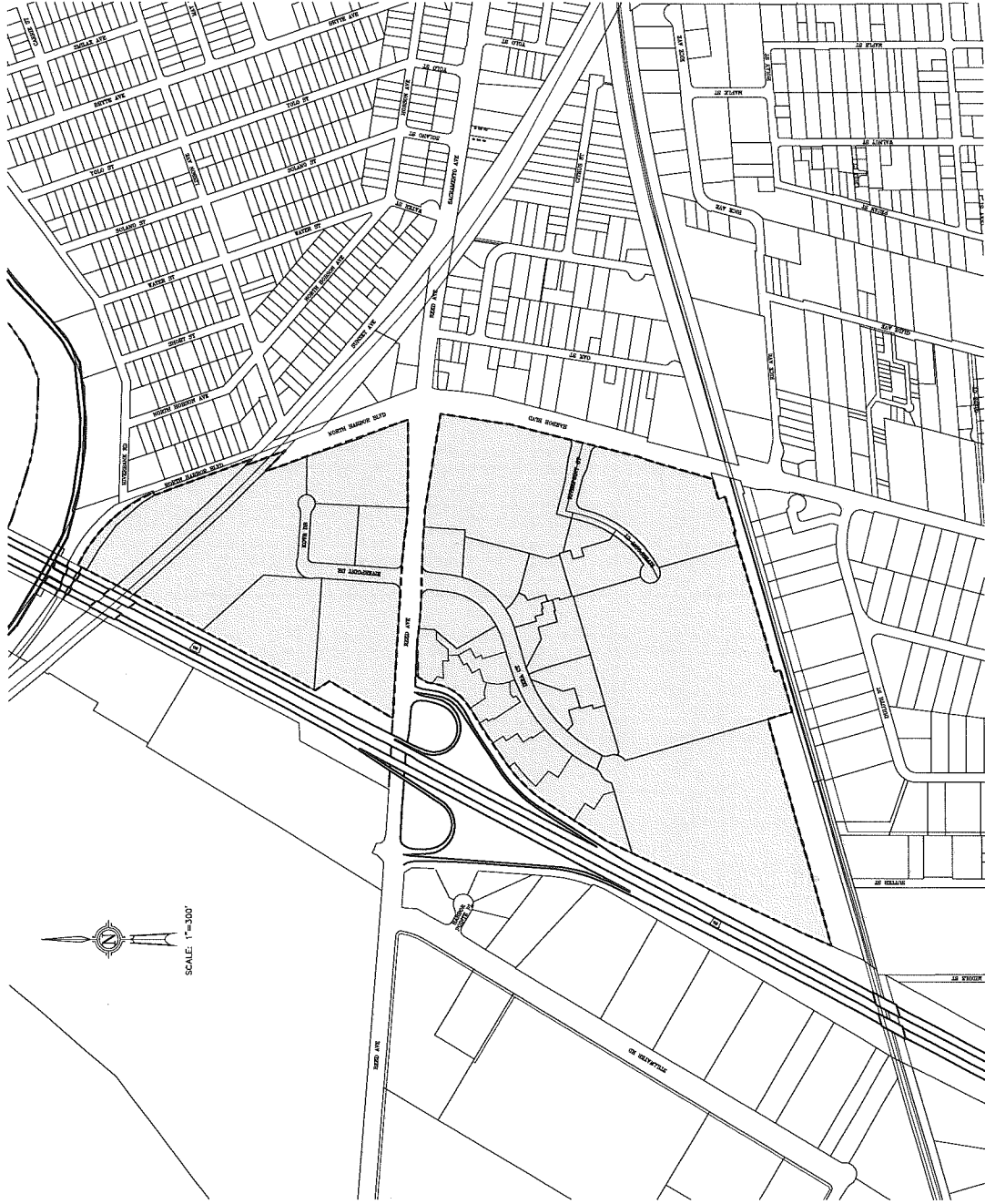

SCALE: 1" = 300'

PROPOSED ENHANCED INFRASTRUCTURE FINANCING DISTRICT
(EIFD) No. 18 - RIVERPOINT
CITY OF WEST SACRAMENTO,
COUNTY OF YOLO,
STATE OF CALIFORNIA

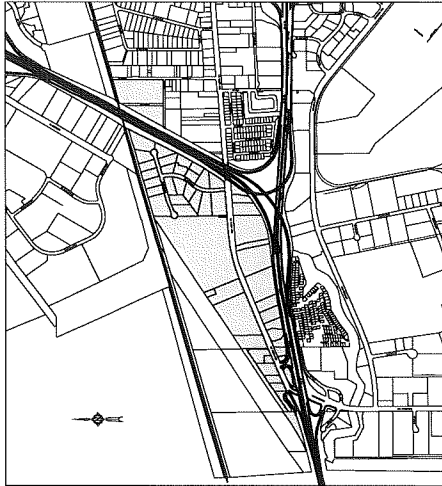

VICINITY MAP
SCALE: 1" = 1200'

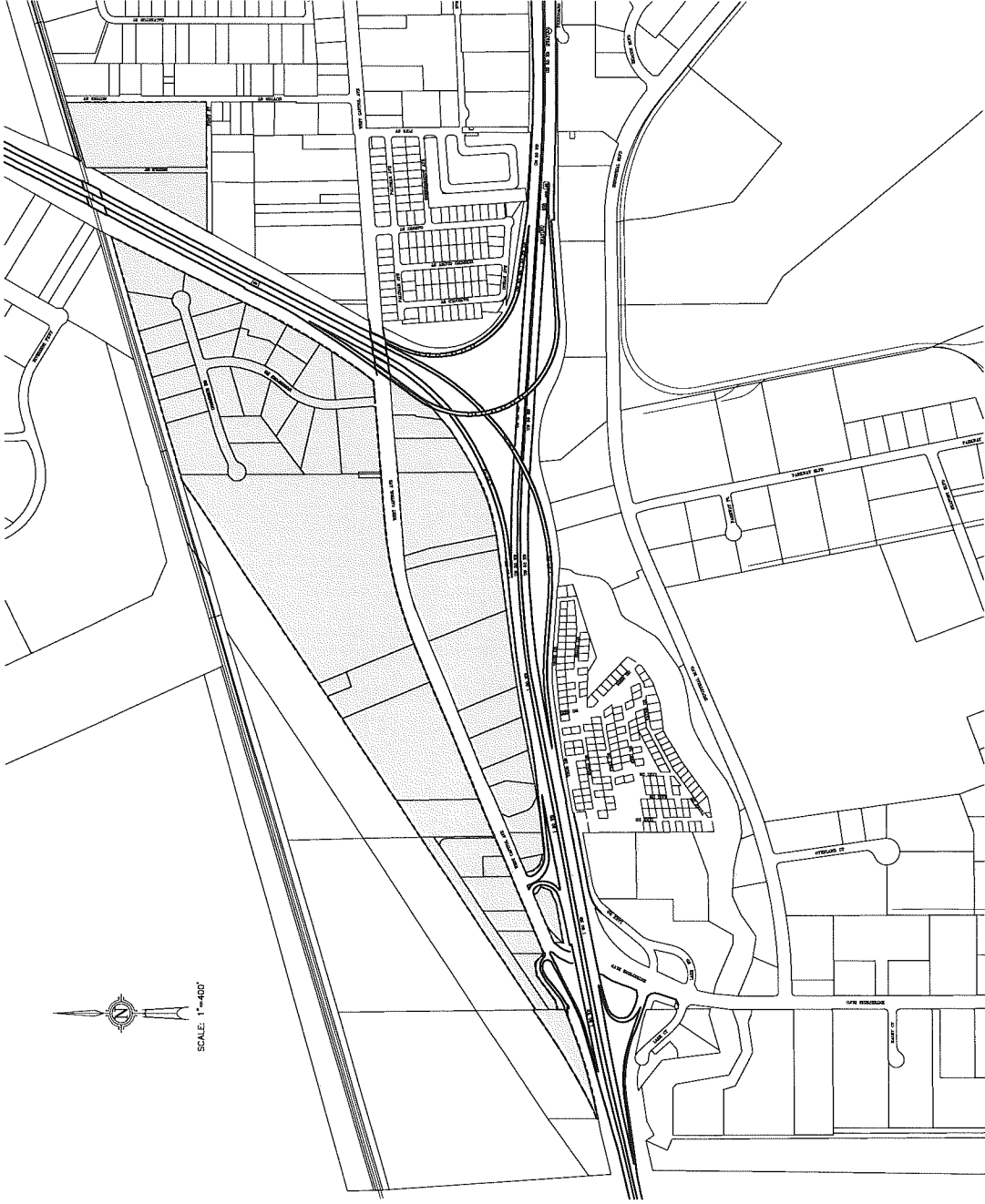

SCALE: 1" = 400'

LEGEND

--- ENHANCED INFRASTRUCTURE FINANCING DISTRICT
(EIFD) No. 10 - WEST END

FILED IN THE OFFICE OF THE CITY CLERK OF THE CITY OF
WEST SACRAMENTO THIS ____ DAY OF _____, 201__.

KRYSS RANKIN
CITY CLERK
CITY OF WEST SACRAMENTO

I HEREBY CERTIFY THAT THIS MAP SHOWING THE PROPOSED BOUNDARIES
OF ENHANCED INFRASTRUCTURE FINANCING DISTRICT No. 10, CITY OF
WEST SACRAMENTO, COUNTY OF YOLO, CALIFORNIA, WAS PREPARED BY
WEST SACRAMENTO CITY ENGINEER, COUNTY OF YOLO, AT A REGULAR
REGULAR MEETING THEREOF, HELD ON THE ____ DAY OF _____,
201__., BY ITS RESOLUTION No. _____.

KRYSS RANKIN
CITY CLERK
CITY OF WEST SACRAMENTO

FILED THIS ____ DAY OF _____, 201__ AT THE HOUR OF ____ O'CLOCK ____ M.,
IN THE OFFICE OF THE COUNTY RECORDER OF
THE COUNTY OF YOLO, STATE OF CALIFORNIA.

COUNTY RECORDER
COUNTY OF YOLO

PROPOSED ENHANCED INFRASTRUCTURE FINANCING DISTRICT
(EIFD) No. 10 - WEST END
CITY OF WEST SACRAMENTO,
COUNTY OF YOLO,
STATE OF CALIFORNIA



VICINITY MAP
SCALE 1" = 1200'

LEGEND

ENHANCED INFRASTRUCTURE FINANCING DISTRICT
(EIFD) No. 1E - IRON TRIANGLE

FILED IN THE OFFICE OF THE CITY CLERK OF THE CITY OF
WEST SACRAMENTO THIS _____ DAY OF _____, 201__.

JAMES RANKIN
CITY CLERK
CITY OF WEST SACRAMENTO

I HEREBY CERTIFY THAT THIS MAP SHOWING THE PROPOSED BOUNDARIES
OF ENHANCED INFRASTRUCTURE FINANCING DISTRICT NO. 1E, CITY OF
WEST SACRAMENTO, CALIFORNIA, WAS APPROVED BY THE CITY COUNCIL OF
WEST SACRAMENTO AT A REGULAR MEETING HELD ON THE _____ DAY OF _____,
201__ , BY ITS RESOLUTION No. _____.

KRYS RANKIN
CITY CLERK
CITY OF WEST SACRAMENTO

FILED THIS _____ DAY OF _____, 201__ AT THE HOUR OF _____ O'CLOCK
P.M. IN THE OFFICE OF THE COUNTY RECORDER OF
THE COUNTY OF YOLO, STATE OF CALIFORNIA.

TERRIE GAYBY
COUNTY RECORDER
COUNTY OF YOLO

PROPOSED ENHANCED INFRASTRUCTURE FINANCING DISTRICT
(EIFD) No. 1E - IRON TRIANGLE
CITY OF WEST SACRAMENTO,
COUNTY OF YOLO,
STATE OF CALIFORNIA



VICINITY MAP
SCALE: 1" = 1000'

LEGEND

ENHANCED INFRASTRUCTURE FINANCING DISTRICT
(EIFD) No. 1F - WASHINGTON/DOWNTOWN

I HEREBY CERTIFY THAT THIS MAP SHOWS THE PROPOSED BOUNDARIES OF ENHANCED INFRASTRUCTURE FINANCING DISTRICT No. 1F, CITY OF WEST SACRAMENTO, COUNTY OF YOLO, STATE OF CALIFORNIA, WAS REGULAR MEETING THEREOF, HELD ON THE _____ DAY OF _____, 20____, BY ITS RESOLUTION No. _____.

KRYSS RANKIN
CITY OF WEST SACRAMENTO

KRYSS RANKIN
CITY OF WEST SACRAMENTO

FILED THIS _____ DAY OF _____, 20____, AT THE HOUR OF _____ O'CLOCK _____, IN THE OFFICE OF THE COUNTY RECORDER OF THE COUNTY OF YOLO, STATE OF CALIFORNIA.

RENÉE OAKLEY
COUNTY OF YOLO



SCALE: 1" = 600'

PROPOSED ENHANCED INFRASTRUCTURE FINANCING DISTRICT
(EIFD) No. 1F - WASHINGTON/DOWNTOWN
CITY OF WEST SACRAMENTO,
COUNTY OF YOLO,
STATE OF CALIFORNIA

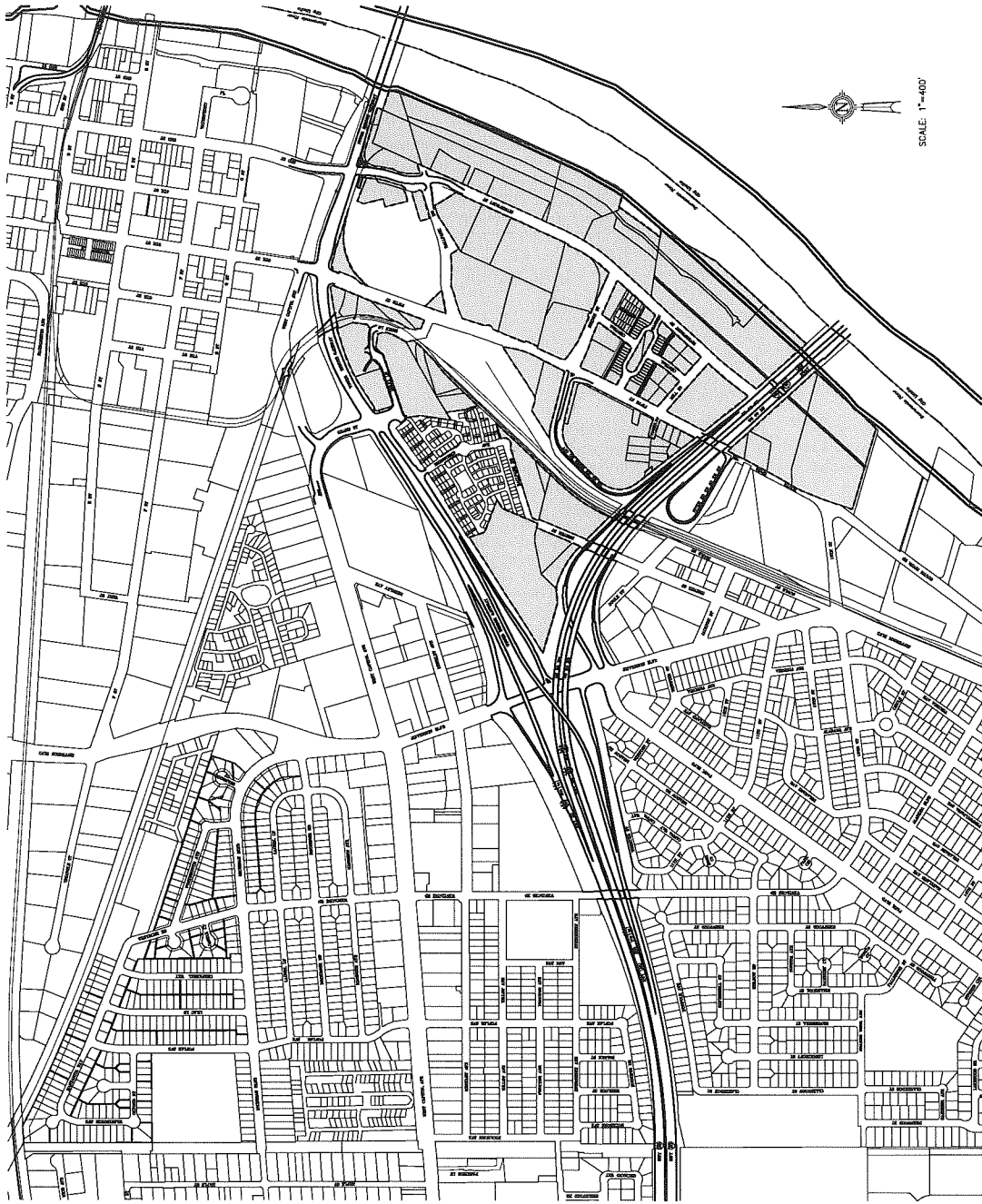

PROPOSED ENHANCED INFRASTRUCTURE FINANCING DISTRICT
 (EIFD) No. 1G - BRIDGE DISTRICT
 CITY OF WEST SACRAMENTO,
 COUNTY OF YOLO,
 STATE OF CALIFORNIA

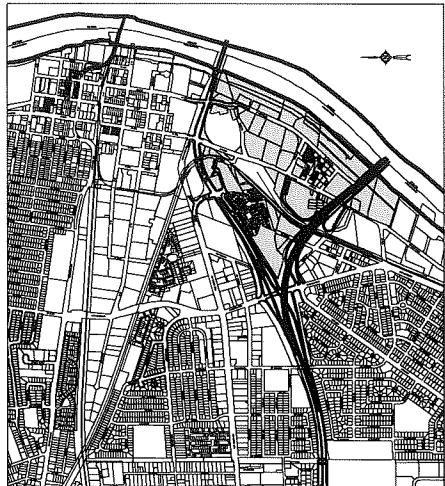

VICINITY MAP
 SCALE: 1" = 1200'

LEGEND

ENHANCED INFRASTRUCTURE FINANCING DISTRICT
 (EIFD) No. 1G - BRIDGE DISTRICT

FILED IN THE OFFICE OF THE CITY CLERK OF THE CITY OF
 WEST SACRAMENTO THIS _____ DAY OF _____, 201__.

KRYSS RANKIN
 CITY CLERK
 CITY OF WEST SACRAMENTO

I HEREBY CERTIFY THAT THIS MAP, SHOWING THE PROPOSED BOUNDARIES
 OF ENHANCED INFRASTRUCTURE FINANCING DISTRICT No. 1G, CITY OF
 WEST SACRAMENTO, COUNTY OF YOLO, STATE OF CALIFORNIA, WAS
 PREPARED AND SUBMITTED TO THE CITY OF WEST SACRAMENTO AT A
 REGULAR MEETING THEREOF, HELD ON THE _____ DAY OF _____,
 201__ , BY ITS RESOLUTION No. _____.

KRYSS RANKIN
 CITY CLERK
 CITY OF WEST SACRAMENTO

FILED THIS _____ DAY OF _____, 201__ , AT THE HOUR OF _____ O'CLOCK
 P.M., IN THE OFFICE OF THE COUNTY RECORDER OF
 THE COUNTY OF YOLO, STATE OF CALIFORNIA.

FREDDIE OAKLEY
 COUNTY RECORDER
 COUNTY OF YOLO



VICINITY MAP
SCALE: 1" = 1200'

LEGEND

ENHANCED INFRASTRUCTURE FINANCING DISTRICT
(EIFD) No. 11 - PIONEER BLUFF

FILED IN THE OFFICE OF THE CITY CLERK OF THE CITY OF WEST SACRAMENTO THIS _____ DAY OF _____, 201__.

KRYSS RANKIN
CITY OF WEST SACRAMENTO

I HEREBY CERTIFY THAT THIS MAP SHOWING THE PROPOSED BOUNDARIES OF ENHANCED INFRASTRUCTURE FINANCING DISTRICT NO. 11, CITY OF WEST SACRAMENTO, COUNTY OF YOLO, IS A TRUE AND CORRECT COPY AS PREPARED BY ME OR UNDER MY CLOSE PERSONAL SUPERVISION AND THAT A REGULAR MEETING THEREOF, HELD ON THE _____ DAY OF _____, 201__., BY ITS RESOLUTION No. _____.

KRYSS RANKIN
CITY OF WEST SACRAMENTO

FILED THIS _____ DAY OF _____, 201__ AT THE HOUR OF _____ O'CLOCK _____ M., IN THE OFFICE OF THE COUNTY RECORDER OF THE COUNTY OF YOLO, STATE OF CALIFORNIA.

RENEE SAKBY
COUNTY RECORDER
COUNTY OF YOLO



PROPOSED ENHANCED INFRASTRUCTURE FINANCING DISTRICT
(EIFD) No. 11 - PIONEER BLUFF
CITY OF WEST SACRAMENTO,
COUNTY OF YOLO,
STATE OF CALIFORNIA

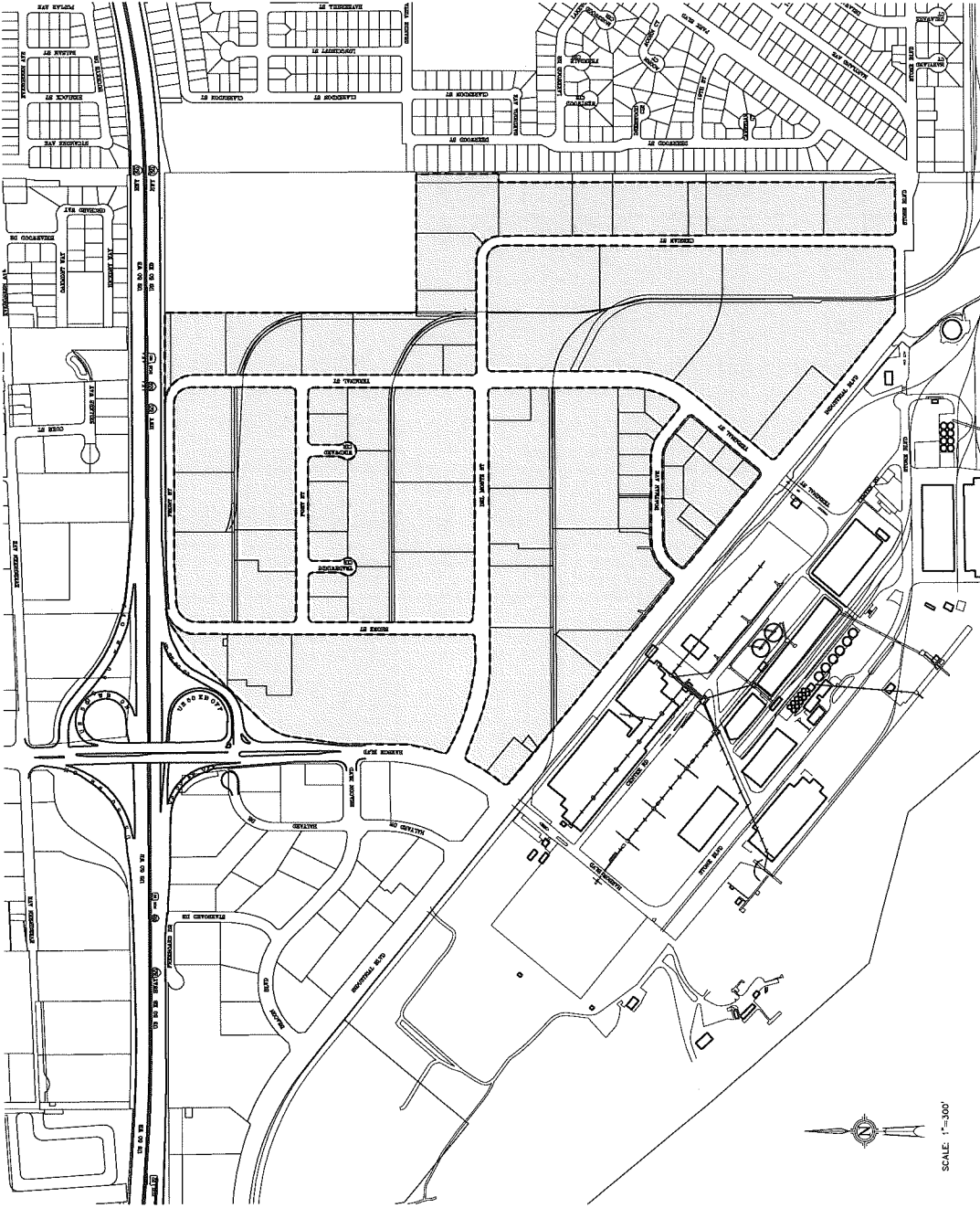

PROPOSED ENHANCED INFRASTRUCTURE FINANCING DISTRICT
 (EIFD) No. 11 - NORTH OF FORT INDUSTRIAL
 CITY OF WEST SACRAMENTO,
 COUNTY OF YOLO,
 STATE OF CALIFORNIA

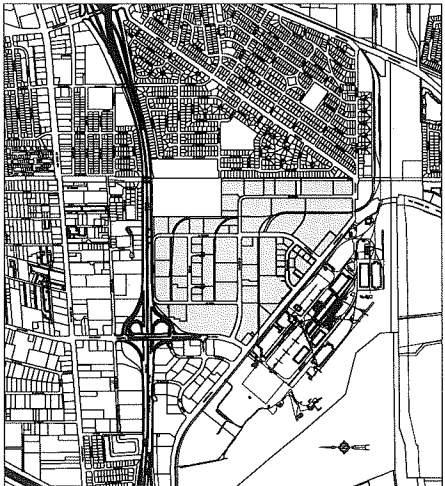

VICINITY MAP
 SCALE: 1" = 1200'

LEGEND

ENHANCED INFRASTRUCTURE FINANCING DISTRICT
 (EIFD) No. 11 - NORTH OF FORT INDUSTRIAL

FILED IN THE OFFICE OF THE CITY CLERK OF THE CITY OF
 WEST SACRAMENTO THIS ____ DAY OF _____, 20__.

KRYSS RANKIN
 CITY CLERK
 CITY OF WEST SACRAMENTO

I HEREBY CERTIFY THAT THIS MAP, SHOWING THE PROPOSED BOUNDARIES
 OF ENHANCED INFRASTRUCTURE FINANCING DISTRICT No. 11, CITY OF WEST
 SACRAMENTO, CALIFORNIA, WAS PREPARED AND SUBMITTED TO THE
 CITY COUNCIL OF THE CITY OF WEST SACRAMENTO AT A REGULAR CITY
 MEETING THEREOF, HELD ON THE ____ DAY OF _____, 20__ BY
 ITS RESOLUTION No. _____.

KRYSS RANKIN
 CITY CLERK
 CITY OF WEST SACRAMENTO

FILED THIS ____ DAY OF _____, 20__ AT THE HOUR OF _____ O'CLOCK
 IN THE OFFICE OF THE COUNTY RECORDER OF
 THE COUNTY OF YOLO, STATE OF CALIFORNIA.

CRISTINE GAWLEY
 COUNTY RECORDER
 COUNTY OF YOLO

SCALE: 1" = 300'



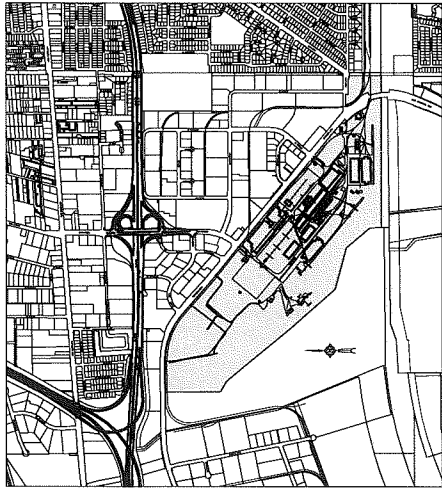

VICINITY MAP
SCALE: 1" = 1200'

LEGEND

ENHANCED INFRASTRUCTURE FINANCING DISTRICT
(EIFD) No. 11 - PORT NORTH TERMINAL

FILED IN THE OFFICE OF THE CITY CLERK OF THE CITY OF WEST SACRAMENTO THIS _____ DAY OF _____, 201__.

KEVIN RANKIN
CITY CLERK
CITY OF WEST SACRAMENTO

I HEREBY CERTIFY THAT THIS MAP SHOWING THE PROPOSED BOUNDARIES OF ENHANCED INFRASTRUCTURE FINANCING DISTRICT No. 11, CITY OF WEST SACRAMENTO, IS A TRUE AND CORRECT COPY OF THE MAP AS APPROVED BY THE CITY COUNCIL OF THE CITY OF WEST SACRAMENTO AT A REGULAR MEETING THEREOF, HELD ON THE _____ DAY OF _____, 201__ BY ITS RESOLUTION No. _____.

KRYSS RANKIN
CITY CLERK
CITY OF WEST SACRAMENTO

FILED THIS _____ DAY OF _____, 201__ AT THE OFFICE OF THE COUNTY RECORDER OF THE COUNTY OF YOLO, STATE OF CALIFORNIA.

CHRISTIE OAKLEY
COUNTY RECORDER
COUNTY OF YOLO

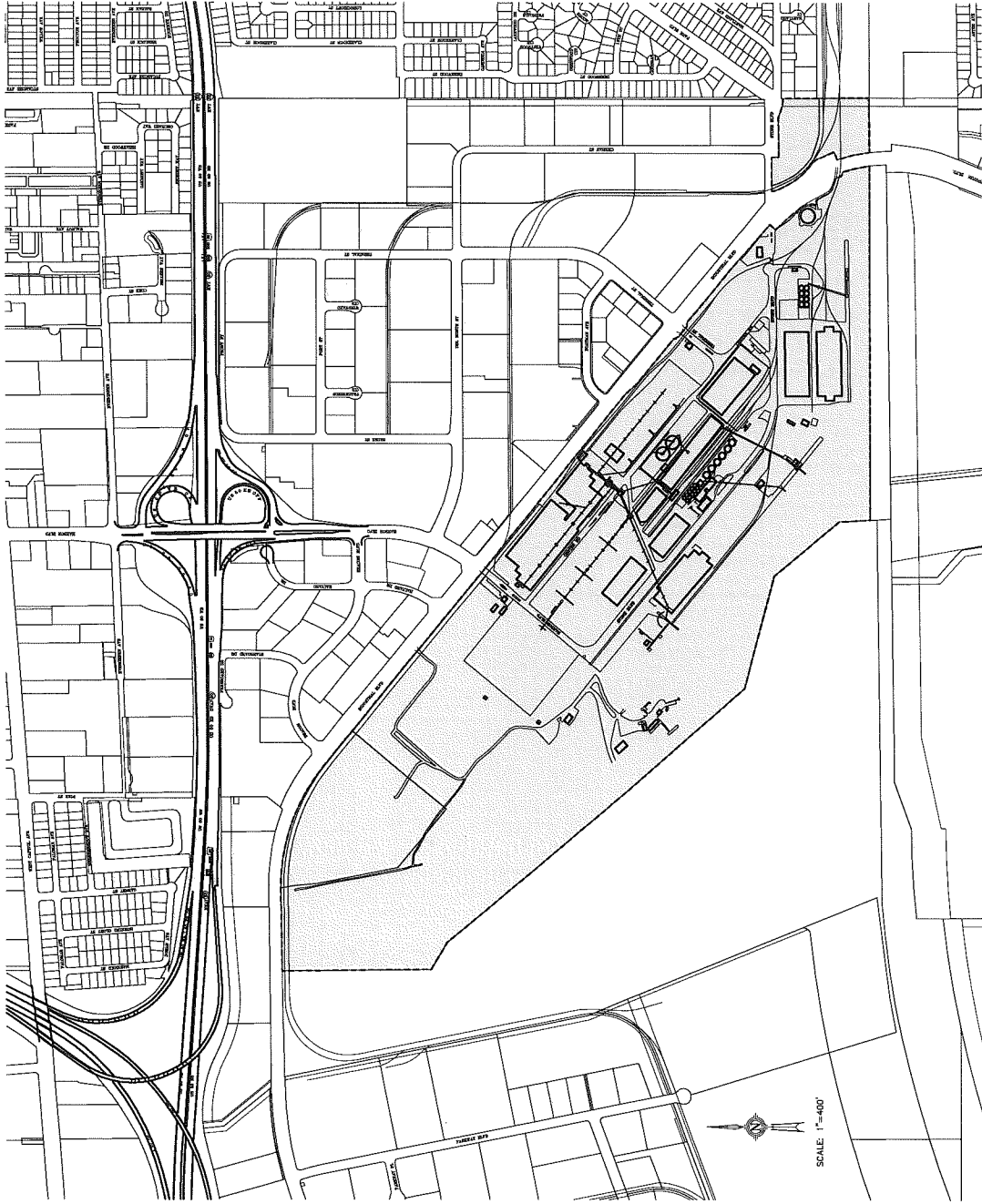

SCALE: 1" = 400'

PROPOSED ENHANCED INFRASTRUCTURE FINANCING DISTRICT
(EIFD) No. 11 - PORT NORTH TERMINAL
CITY OF WEST SACRAMENTO,
COUNTY OF YOLO,
STATE OF CALIFORNIA

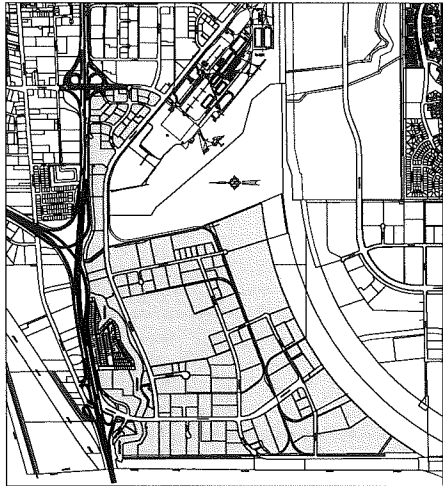

VICINITY MAP
SCALE: 1" = 1500'

LEGEND

— ENHANCED INFRASTRUCTURE FINANCING DISTRICT
(EIFD) No. 1K - PORT OF SACRAMENTO INDUSTRIAL PARK

FILED IN THE OFFICE OF THE CITY CLERK OF THE CITY OF
WEST SACRAMENTO THIS _____ DAY OF _____,
20____.

KAYES RANKIN
CITY CLERK
CITY OF WEST SACRAMENTO

I HEREBY CERTIFY THAT THIS MAP SHOWING THE PROPOSED BOUNDARIES
OF ENHANCED INFRASTRUCTURE FINANCING DISTRICT 1K, CITY OF
WEST SACRAMENTO, WAS PREPARED AND SUBMITTED TO THE CITY COUNCIL OF THE CITY OF WEST SACRAMENTO AT A
REGULAR MEETING HELD ON THE _____ DAY OF _____,
20____, BY ITS RESOLUTION No. _____.

KAYES RANKIN
CITY CLERK
CITY OF WEST SACRAMENTO

FILED THIS _____ DAY OF _____, 20____, AT THE HOUR OF _____ O'CLOCK
IN BOOK _____ OF MAPS, AT PAGE _____, IN THE OFFICE OF THE COUNTY RECORDER OF
THE COUNTY OF YOLO, STATE OF CALIFORNIA.

FREDDIE OAKLEY
COUNTY RECORDER
COUNTY OF YOLO



SCALE: 1" = 600'

PROPOSED ENHANCED INFRASTRUCTURE FINANCING DISTRICT
(EIFD) No. 1K - PORT OF SACRAMENTO INDUSTRIAL PARK
CITY OF WEST SACRAMENTO,
COUNTY OF YOLO,
STATE OF CALIFORNIA

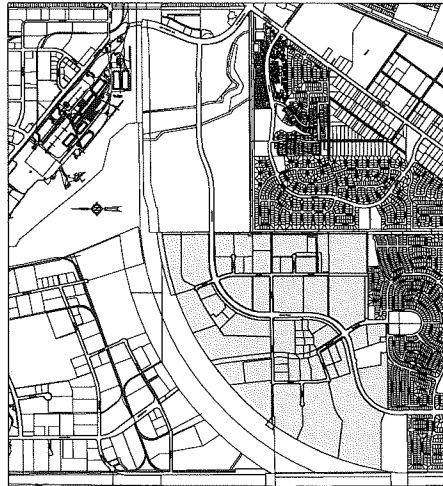

VICINITY MAP
SCALE: 1" = 1500'

LEGEND

ENHANCED INFRASTRUCTURE FINANCING DISTRICT
(EIFD) No. 1L - SOUTHFORT INDUSTRIAL PARK

FILED IN THE OFFICE OF THE CITY CLERK OF THE CITY OF WEST SACRAMENTO THIS _____ DAY OF _____, 201____.

KINGS BANKIN
CITY CLERK
CITY OF WEST SACRAMENTO

I HEREBY CERTIFY THAT THIS MAP SHOWING THE PROPOSED BOUNDARIES OF ENHANCED INFRASTRUCTURE FINANCING DISTRICT No. 1L, CITY OF WEST SACRAMENTO, IS CORRECT AND TRUE TO THE RECORDS OF THE CITY OF WEST SACRAMENTO AT A REGULAR MEETING THEREOF, HELD ON THE _____ DAY OF _____, 201____, BY THE RESOLUTION No. _____.

KINGS BANKIN
CITY CLERK
CITY OF WEST SACRAMENTO

FILED THIS _____ DAY OF _____, 201____, AT THE OFFICE OF THE CLERK OF THE COUNTY RECORDER OF THE COUNTY OF YOLO, STATE OF CALIFORNIA.

TERRIE OAKLEY
COUNTY RECORDER
COUNTY OF YOLO



SCALE: 1" = 800'

PROPOSED ENHANCED INFRASTRUCTURE FINANCING DISTRICT
(EIFD) No. 1L - SOUTHFORT INDUSTRIAL PARK
CITY OF WEST SACRAMENTO,
COUNTY OF YOLO,
STATE OF CALIFORNIA



VICINITY MAP
SCALE: 1" = 1600'

LEGEND

[Shaded Area] ENHANCED INFRASTRUCTURE FINANCING DISTRICT
[Dashed Line] (EIFD) No. 1M - SEAWAY

FILED IN THE OFFICE OF THE CITY CLERK OF THE CITY OF WEST SACRAMENTO THIS ____ DAY OF _____, 201__.

URSUS PANKIN
CITY CLERK
CITY OF WEST SACRAMENTO

I HEREBY CERTIFY THAT THIS MAP SHOWING THE PROPOSED BOUNDARIES OF ENHANCED INFRASTRUCTURE FINANCING DISTRICT No. 1M, CITY OF WEST SACRAMENTO, IS A TRUE AND CORRECT COPY OF THE MAP AS APPROVED BY THE CITY COUNCIL OF THE CITY OF WEST SACRAMENTO AT A REGULAR MEETING THEREOF, HELD ON THE ____ DAY OF _____, 201__ BY ITS RESOLUTION NO. _____.

URSUS PANKIN
CITY CLERK
CITY OF WEST SACRAMENTO

FILED THIS ____ DAY OF _____, 201__ AT THE OFFICE OF THE COUNTY RECORDER OF THE COUNTY OF YOLO, STATE OF CALIFORNIA.

FREDRICK OAKLEY
COUNTY RECORDER
COUNTY OF YOLO

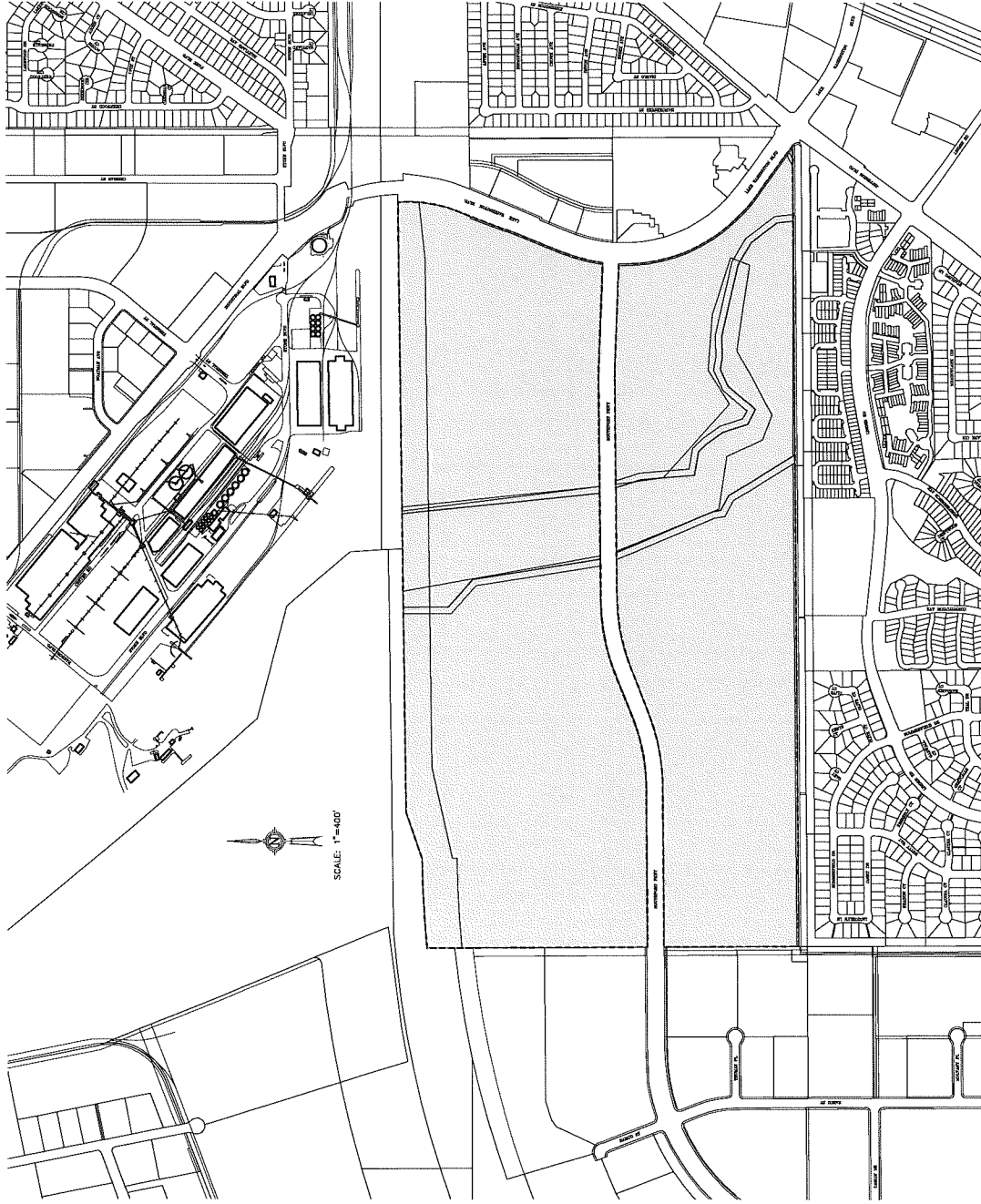

SCALE: 1" = 400'

PROPOSED ENHANCED INFRASTRUCTURE FINANCING DISTRICT
(EIFD) No. 1M - SEAWAY
CITY OF WEST SACRAMENTO,
COUNTY OF YOLO,
STATE OF CALIFORNIA



VICINITY MAP
SCALE: 1" = 1600'

LEGEND

ENHANCED INFRASTRUCTURE FINANCING DISTRICT
(EIFD) No. IN - STONE LOCK

FILED IN THE OFFICE OF THE CITY CLERK OF THE CITY OF WEST SACRAMENTO THIS ____ DAY OF ____ 201__.

DEBBIE BANKIN
CITY CLERK
CITY OF WEST SACRAMENTO

I HEREBY CERTIFY THAT THIS MAP SHOWING THE PROPOSED BOUNDARIES OF ENHANCED INFRASTRUCTURE FINANCING DISTRICT No. IN, CITY OF WEST SACRAMENTO, WAS PREPARED AND SUBMITTED TO THE CITY COUNCIL OF THE CITY OF WEST SACRAMENTO AT A REGULAR MEETING THEREOF HELD ON THE ____ DAY OF ____ 201__ BY ITS RESOLUTION No. _____.

DEBBIE BANKIN
CITY CLERK
CITY OF WEST SACRAMENTO

FILED THIS ____ DAY OF ____ 201__ AT THE HOUR OF ____ O'CLOCK P.M. IN BOOK ____ OF MAPS, AT PAGE ____ IN THE OFFICE OF THE COUNTY RECORDER OF THE COUNTY OF YOLO, STATE OF CALIFORNIA.

FREDIE OAKLEY
COUNTY RECORDER
COUNTY OF YOLO



PROPOSED ENHANCED INFRASTRUCTURE FINANCING DISTRICT
(EIFD) No. IN - STONE LOCK
CITY OF WEST SACRAMENTO,
COUNTY OF YOLO,
STATE OF CALIFORNIA